

All dimensions based on stackup of sheetmetal, subject to variation of 1/2" (13 mm)

Air & Power

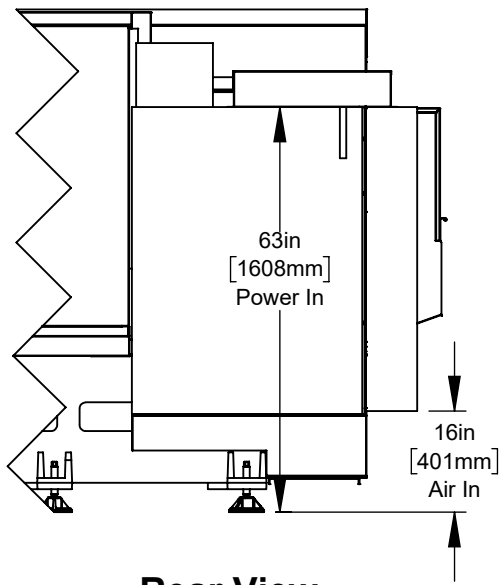

Rear View

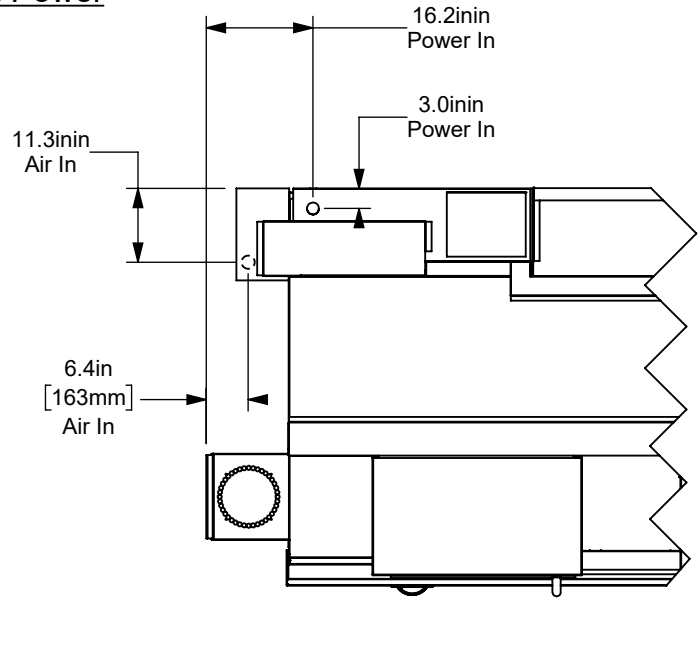

Top View

Height Breakdown

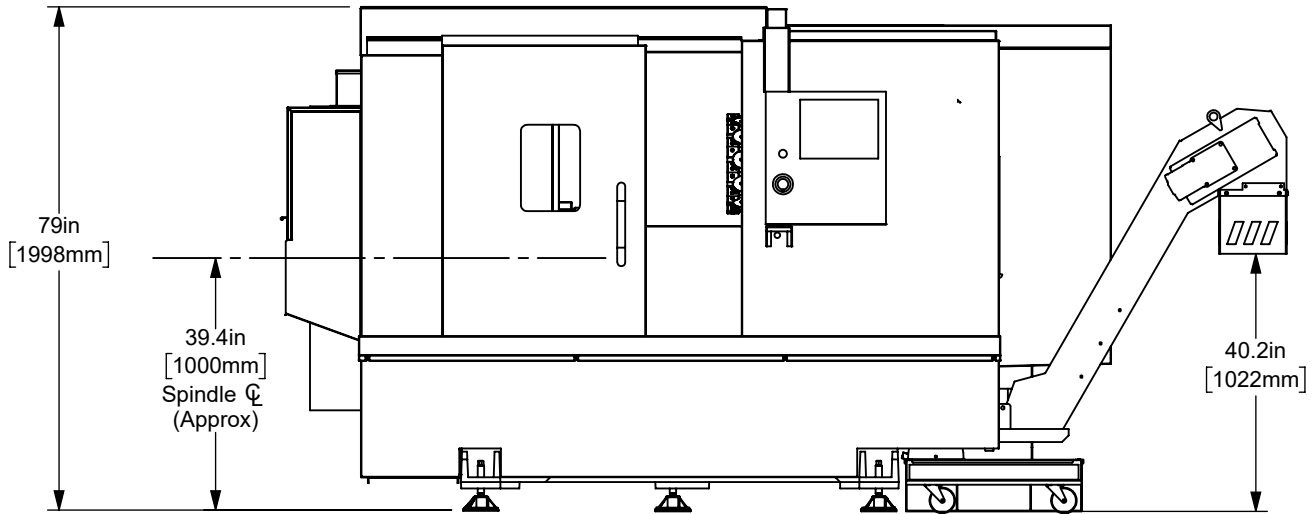

All dimensions based on stackup of sheetmetal, subject to variation of 1/2" (13 mm)

Width Breakdown

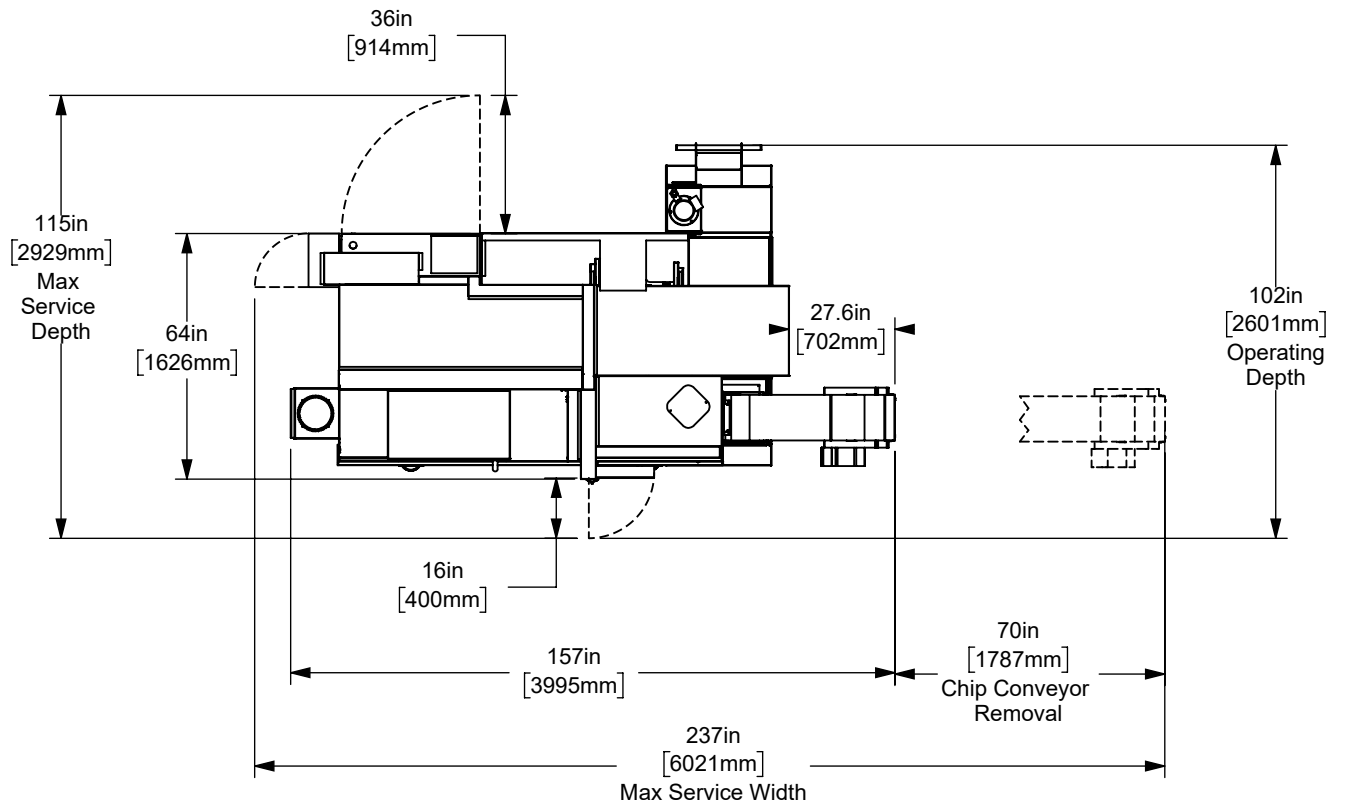

All dimensions based on stackup of sheetmetal, subject to variation of 1/2" (13 mm)

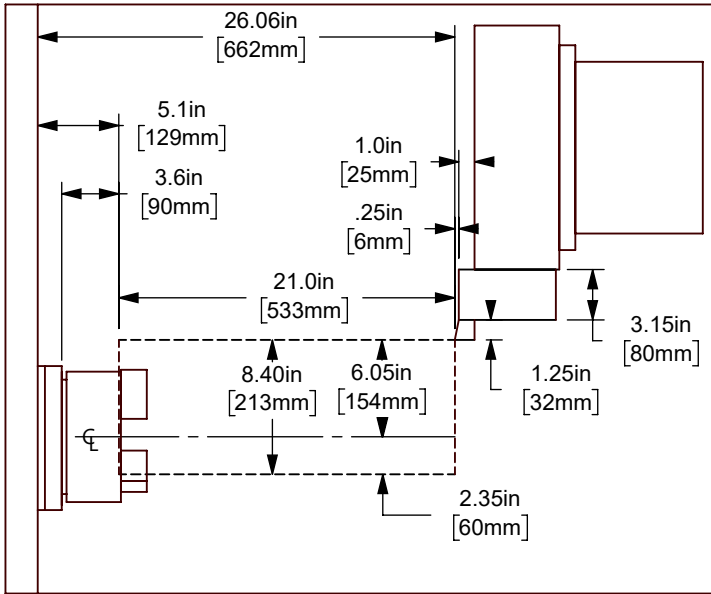

BMT OD

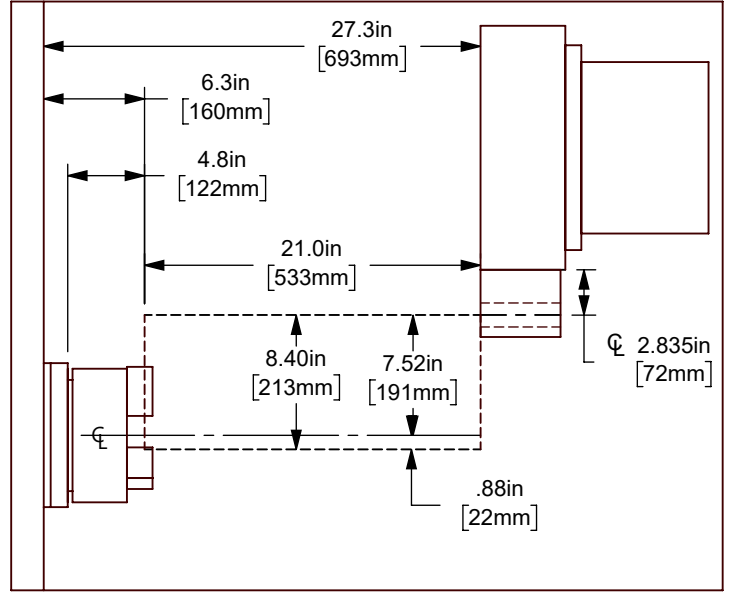

BMT ID / Drill / Bore (*) **

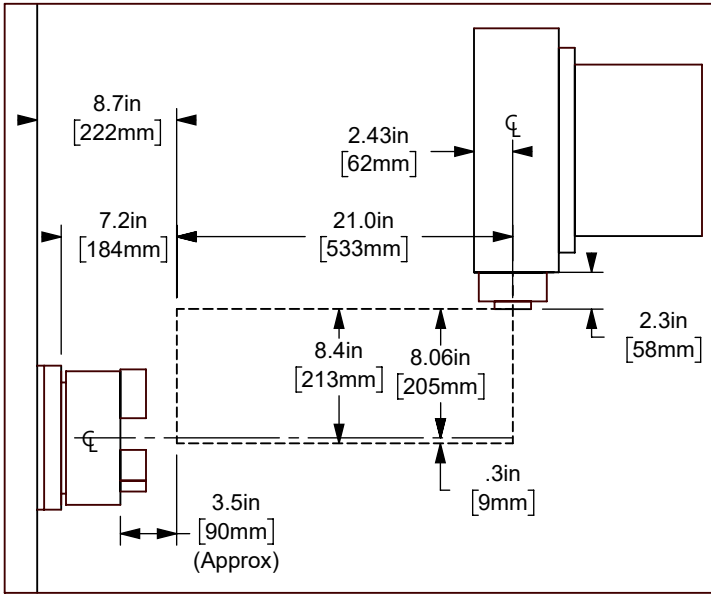

BMT Live Cross Tool *

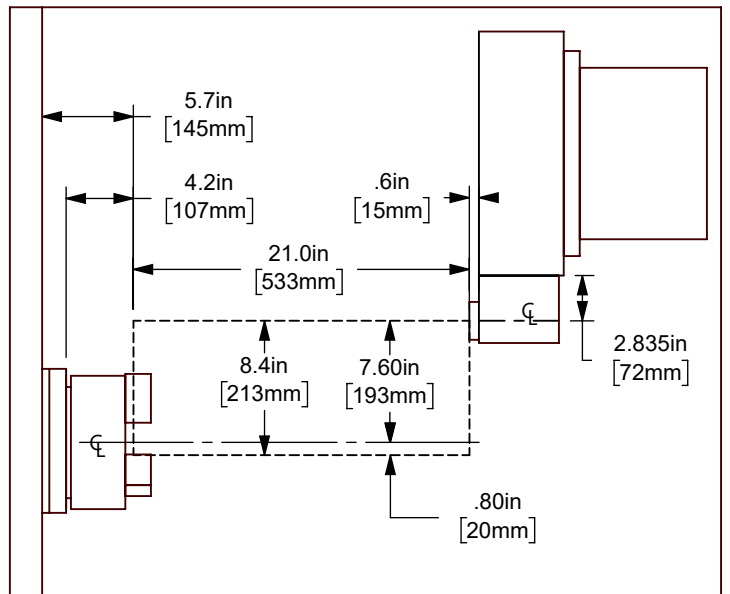

BMT Live Face Tool **

* Shift the work envelope in X by the tool protrusion length

** Shift the work envelope in Z by the tool protrusion length

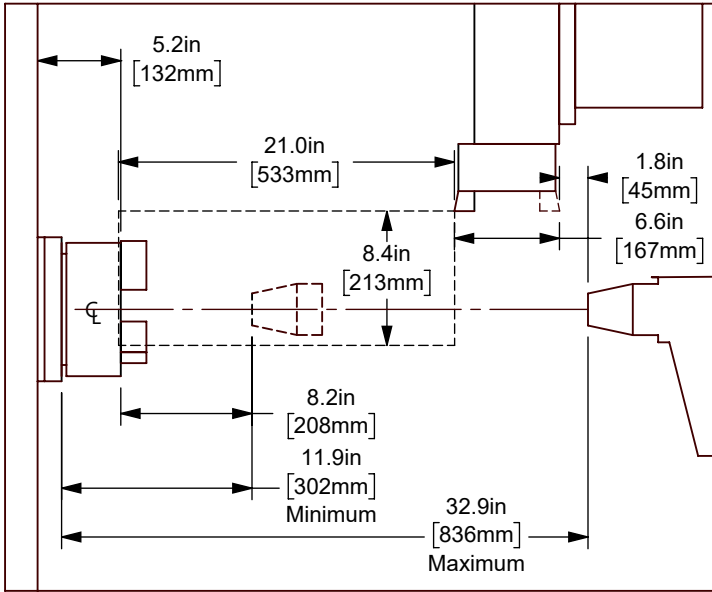

Tailstock Option

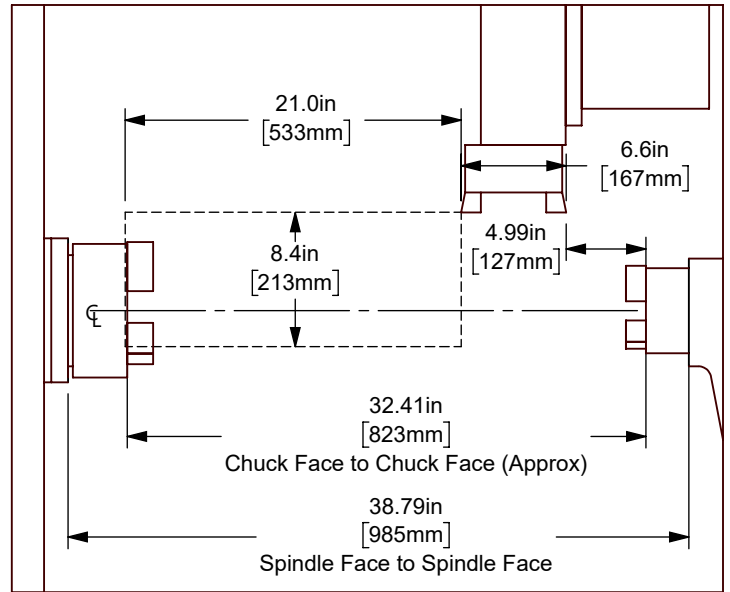

Sub Spindle Option

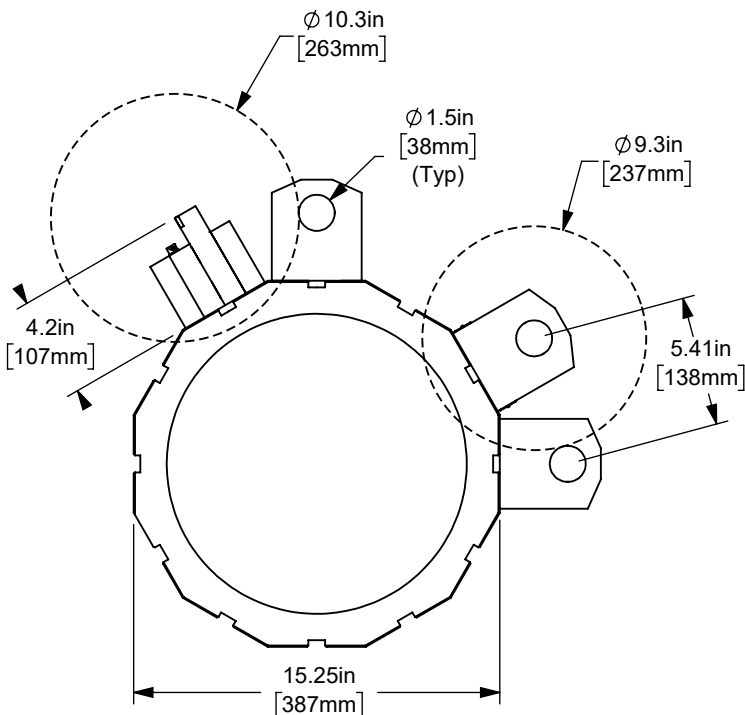

BMT65 Basic Tool Clearance

Maximum Turret Swing Ø 35.0in [889mm]

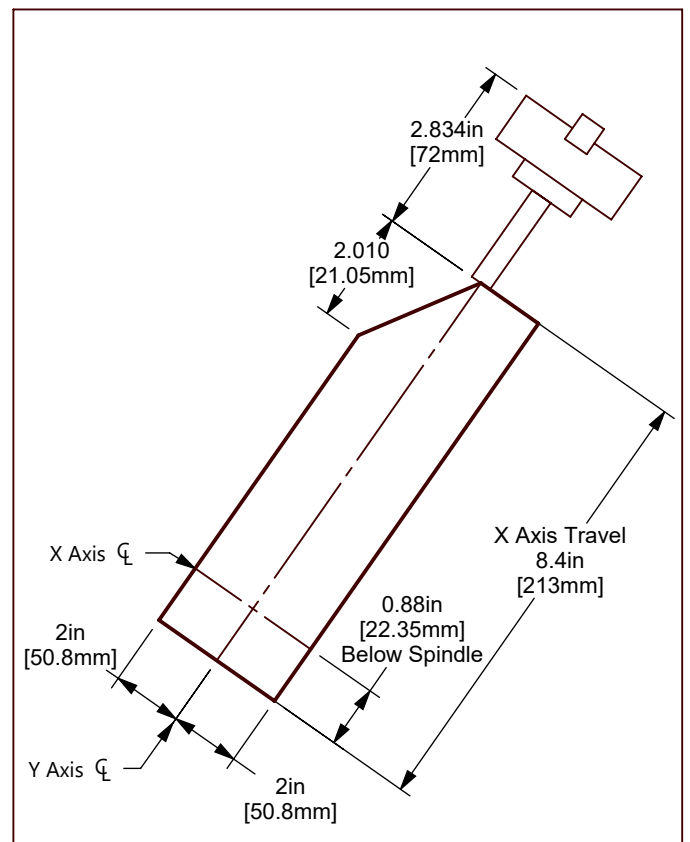

Y Axis Travel Envelope

Same Dimensions Apply To 90° Live Face Tool

Bar Feeder Layout

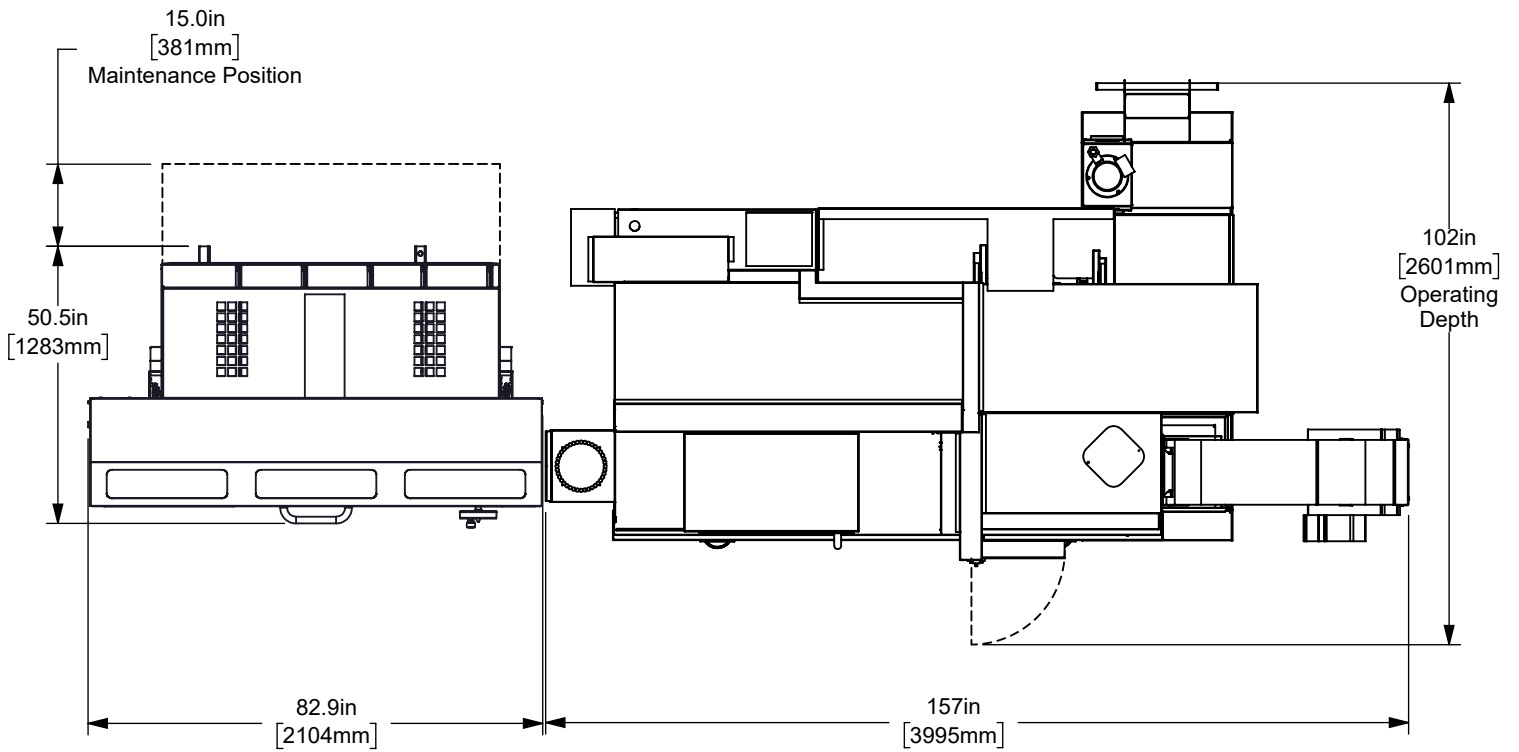

All dimensions based on stackup of sheetmetal, subject to variation of 1/2" (13 mm)

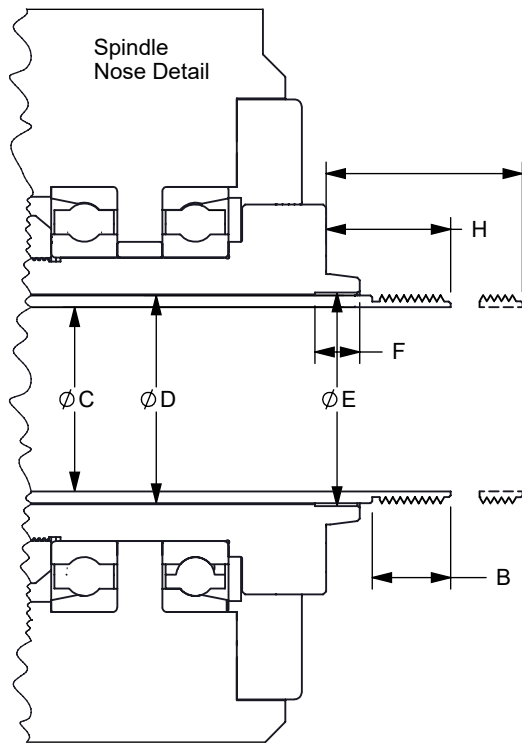
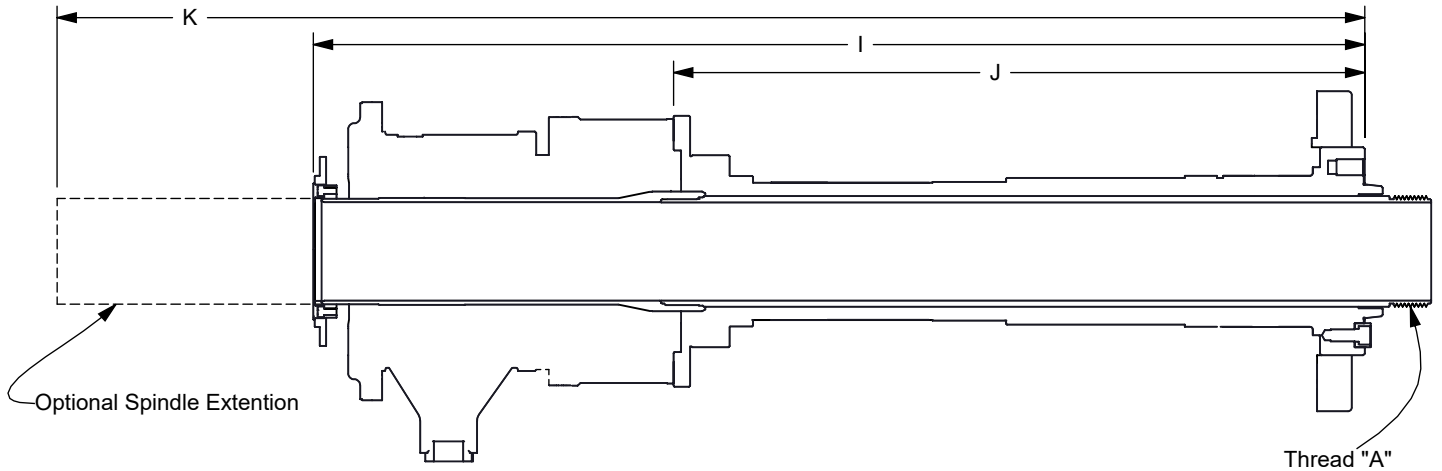

BHC and Spindle Nose dimensions per American Standard Bulletin ASA B5.9 1960

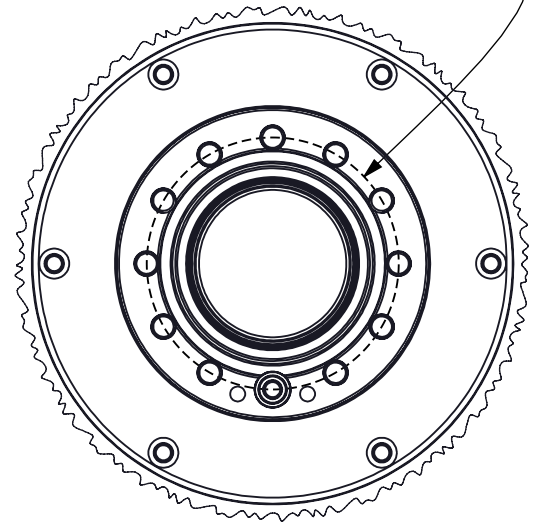

The following dimensions should be used as a reference only. Haas uses many different vendors for our drawtube assemblies. If any custom workholding is required Haas recommends you retrieve the exact dimensions from your delivered machine.

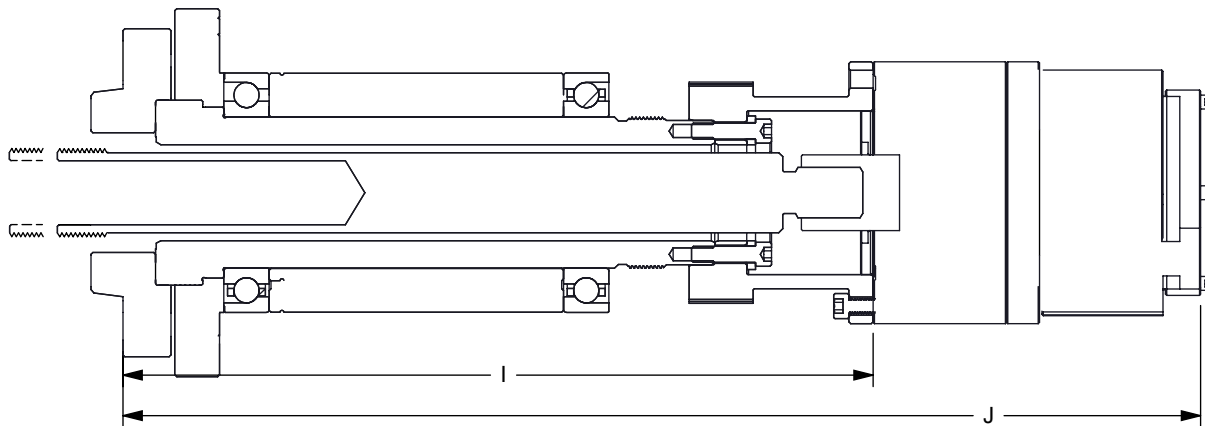

BHC and Spindle Nose dimensions per
American Standard Bulletin ASA B5.9 1960

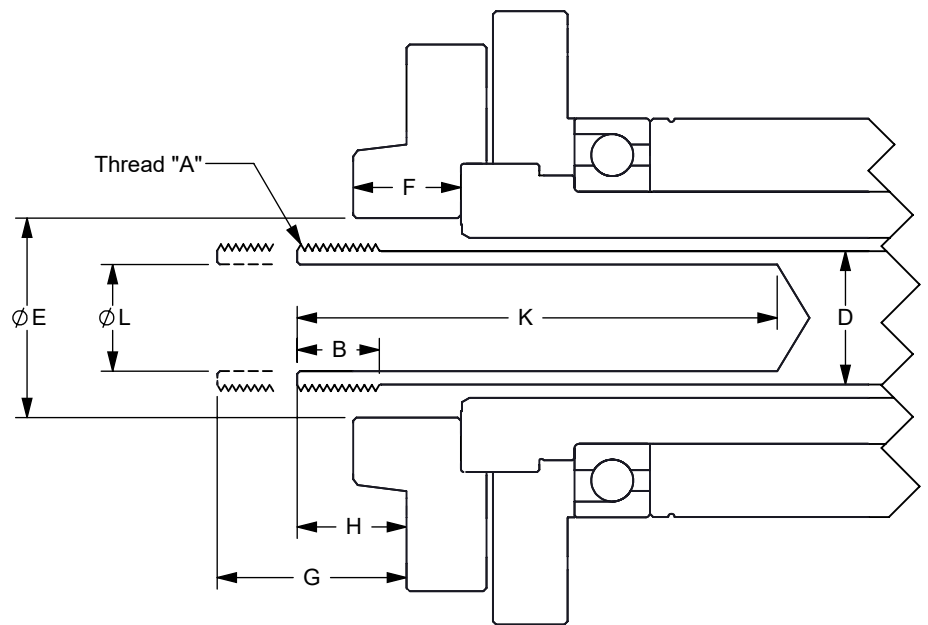
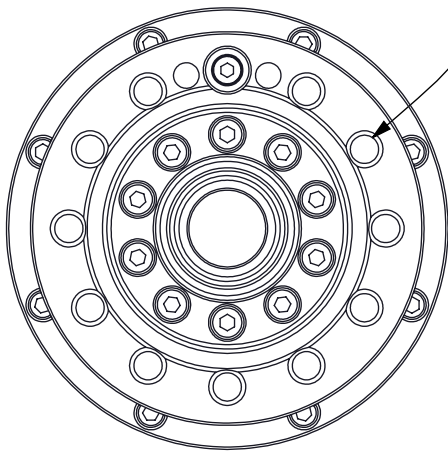

The following dimensions should be used as a reference only. Haas uses many different vendors for our drawtube assemblies. If any custom workholding is required Haas recommends you retrieve the exact dimensions from your delivered machine.

SUB-SPDL-A2-5 for ST-10 to ST-25			
DESCRIPTION	DIMENSION	SAE	METRIC
MAIN OR SUB SPINDLE & TYPE		Sub-Spindle / A2-5	
DIAMETER OF THREAD	A	1.378"	35 MM* or 40 MM
THREAD PITCH	A	0.059"	1.5 MM
INTERNAL OR EXTERNAL	A	External	
LENGTH OF THREAD	B	0.50"	12.7 MM
DRAWTUBE INNER DIAMETER	C	N/A - SOLID DRAWBAR	
DRAWTUBE OUTER DIAMETER	D	1.25"	31.75MM
COUNTERBORE INNER DIAMETER	E	1.870"	47.5 MM
COUNTERBORE DEPTH	F	1.01"	25.65MM
EXTENDED DISTANCE TO NOSE	G	1.465"	37.2 MM
RETRACTED DISTANCE TO NOSE	H	0.874"	22.2 MM
FROM SPINDLE FACE TO BACK OF UNION	I	11.72	297.7MM
FROM SPINDLE FACE TO UNION ADAPTOR	J	16.84	427.7MM
EJECTOR POCKET DEPTH	K	4.5"	114.3MM
EJECTOR POCKET DIAMETER	L	1.0"	25.4MM

*M35 applies to Sub-Spindles made after July 2019 - M40 applies to older vintages